

Arkal 3” Twin Lite Filter with a detachable spine

Catalog No. **1326 3** ___ Threaded BSPT
1327 3 ___ Threaded NPT
1325 3 ___ Victaulic
1325 5 ___ Arkal Flange

Features

- Inlet / Outlet options 3"- VIC, AR-Flange, Threaded
- Parts in contact with water are made of polypropylene
- Highly resistant to corrosion
- Detachable spine
- Pressure differential disc compression
- Available in various filtration grades
- Unique polymeric clamp
- Drain ball valve

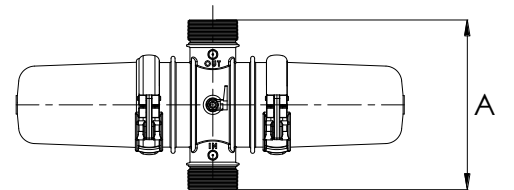
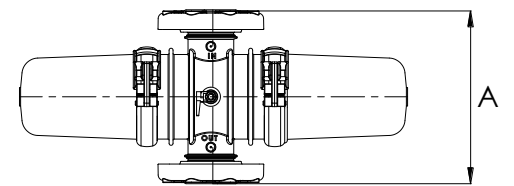
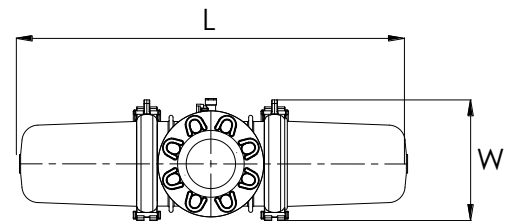

Technical Data

Inlet/Outlet diameter	3” Arkal Flange / Threaded / Grooved	
Max. Pressure	8 bar	116 psi
Max. Flow rate 400-100 micron	50 m ³ /h (13.9 l/sec)	220 gpm
70 micron	40 m ³ /h (11.1 l/sec)	176 gpm
55 micron	34 m ³ /h (8.9 l/sec)	150 gpm
20 micron	16 m ³ /h (4.4 l/sec)	70 gpm
Filtration area	1900 cm ²	294 in ²
Filtration volume	2450 cm ³	150 in ³
Filter width W	225 mm	8 ²⁷ / ₃₂ ”
Filter length L	730 mm	28 ³ / ₄ ”
Distance between connections A	320 mm	12 ¹⁹ / ₃₂ ”
Weight (Victaulic, Threaded)	6.3 Kg	14 lbs
Weight (Flanged)	7.8 Kg	17 lbs
Maximum temperature	60° C	140° F
pH	2-13	

Filtration Grades

- 1 - Blue (400 micron / 40 mesh)
- 2 - Yellow (200 micron / 80 mesh)
- 3 - Red (130 micron / 120 mesh)
- 4 - Black (100 micron / 140 mesh)
- 5 - Brown (70 micron)
- 6 - Green (55 micron)
- 7 - Grey (20 micron)

Headloss Chart

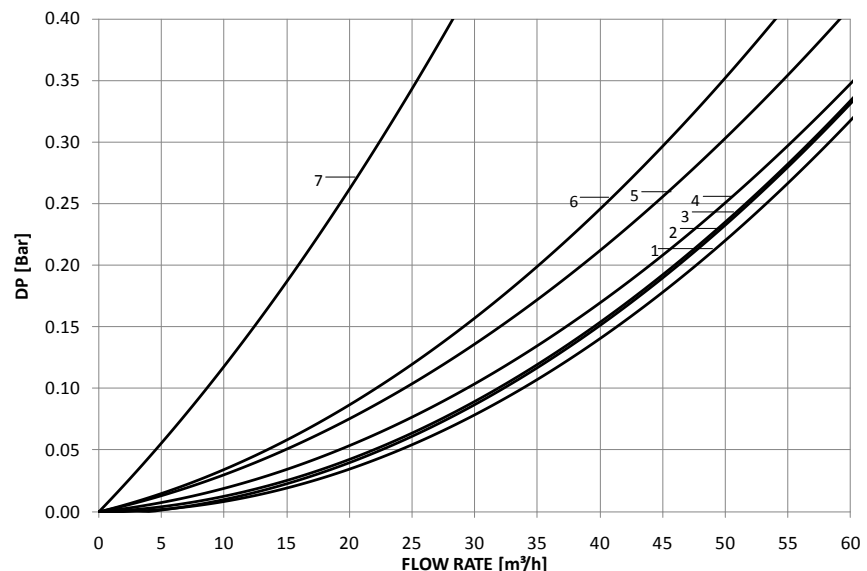

Installation Recommendations

FRONT VIEW

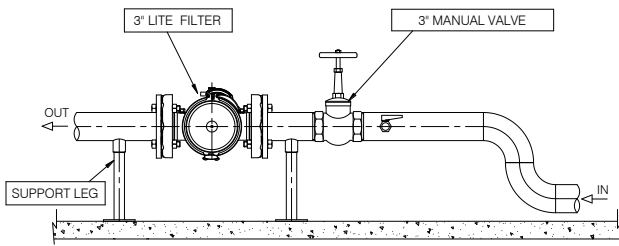

TOP VIEW

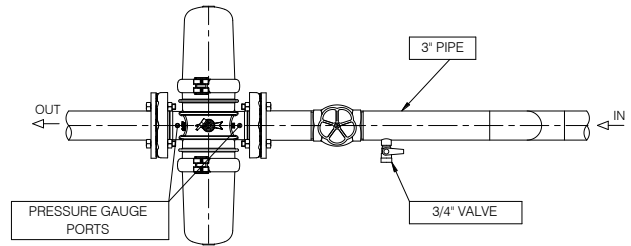

Dismantling

1. Turn off the water.
2. Release the pressure through the drainage ball valve.
3. Open the filter clamp and remove the cover.
4. Unscrew and remove the filter element.
5. Wash the filter element.
6. If the filter discs require acid treatment you may dip the complete filter element in acid according to our recommendation.

Assembly

1. Place the filter element, turn clockwise until secure. Verify that the filter element is tightened in place.
2. Place the cover and attach the clamp. Verify that the clamp is securely locked.

Winterization:

To prevent filter damage due to freezing water - drain all the water from the filter and leave the drain valve open.

Part List

No.	Cat. No.	Description	Materials
1	2501 0202	Filter cover	PP
2	5003 2361	O-ring 2-361(151.77x5.33)	EPDM
3	2253 0235	Clamp	RPA
4	2126 1_ _ _	Filter element	PP
5	5006 0004	Gauge port seal	EPDM
6	2511 0103	Gauge port nut	RPP
7	5054 0212	½" ball valve	BRASS
8	2232 5013	Body + flanges Assembly	-
	2232 1013	Body grooved Assembly	-
	2232 0013	Body threaded BSPT Assembly	-
	2232 0014	Body threaded NPT Assembly	-
9	2510 0325	Ring flange 3"	RPA
10	2507 0308	Cone flange	POM
11	5005 2013	Gasket 3"	EPDM
12	2253 0325	Flange complete	-

Materials

PP - POLYPROPYLENE

RPA - REINFORCED POLYAMIDE

RPP - REINFORCED POLYPROPYLENE

POM - ACETAL

Note:

- This filter is equipped with a pressure safety device. If pressure exceeds the maximum work pressure, the seal will act as a pressure release element. If such occurs, please open the clamp, place the seal on the cover and reassemble.
- Before opening the filter clamp, check that there is no pressure on the filter.

