

NEW SPINE REV. 2.8, FOR ARKAL SPIN KLIN™ PRODUCTS

In August 2018, we sent you a Product Change Notification regarding our **New Spine Rev. 2.8, for Arkal Spin Klin™ products**.

As explained, since the mold for the Spin Klin™ 2.7 spine needed replacing, we took the opportunity to also make improvements based on years of field experience and value engineering considerations.

The new 2.8 spine is compatible to the 2.7 spine, so the spine can be replaced on-site, without having to change the filter.

We have compiled this document highlighting the improvements, for your easy reference.

Overview

| Description | Old 2.7 | New 2.8 |
|-------------|--|---|
| Status | Mold was in use since 2007. Needed replacing. | Mold in use from 2019. Optimized raw material flow within the mold for more stable and higher quality products. |
| Nozzles | Spray in a counterclockwise direction. Over time, this may have caused the spine to open, due to the surplus energy created by the spinning of the discs during backwash. | Spray in a clockwise direction. This minimizes the possibility of the spine opening, as the spin is in the opposite direction. |
| Versions | 1 version: Short – for the complete Spin Klin™ line. An adaptor was needed for the 2"-3" products. | 2 versions: Long – for the 2" & 3" filter. Eliminates the need for an adapter. Short – for the complete Galaxy product line and for replacing existing spine on-site. |

Spine Colors: Black: Standard (RPA) | Grey: DW (RPP)

Physical Differences Between Spin Klin™ 2.7 and 2.8 Spines



Change of direction in the spray nozzles



Ports that were not in use were removed

Spin Klin™ Spine 2.8: All Configurations

Long Spine

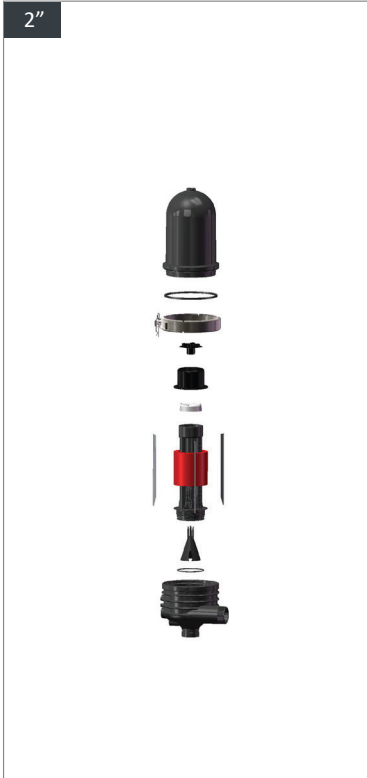

Short Spine

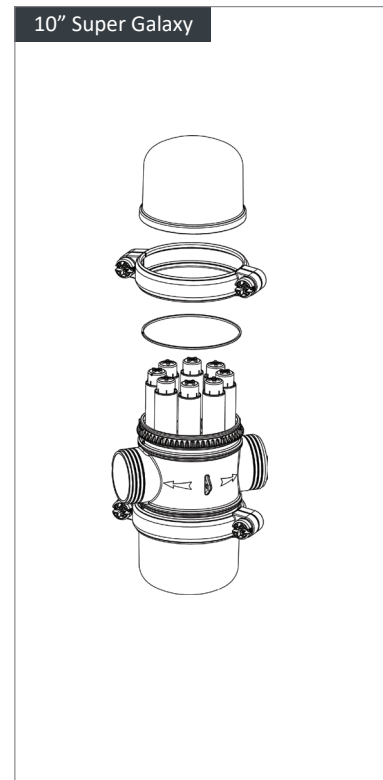

Upgrading Current 2.7 Spine to 2.8 Spine

A. Long-Base Spine for 2" & 3" Spin Klin™ Filters - Follow the steps below:

1 Remove filter cover and pull out the **2.7 spine assembly**.

2 Disassemble the **spine adaptor** by turning it counterclockwise:



3 Pull out the **spine adaptor**:



4 Insert the new **long-base 2.8 spine assembly**.

5 Using a short-base 2.8 spine for 2" & 3" Spin Klin™ filters is possible if spine adaptor is not removed.



B. Short-Base Spine for 4" Galaxy and 10" Super Galaxy Filters - Spines are interchangeable (no adjustments required).

Galaxy Spin Klin spare parts and full product online orders, www.irrigationglobal.com

new spine 2020 online ordering ARKAL by amiad